

# SMD Seam Sealing Crystals 5.0 x 3.2 x 0.9 mm AB Series



## Features

- Reliable seam sealed ceramic package.
- Wide operating temperature range.
- Superior and reliable performance in harsh environment.
- Application: TPMS, ECM, ABS and sensor modules.
- RoHS Compliant / Pb Free.

## Electrical Specifications

| Item / Type  | AB                               |
|--|----------------------------------|
| Frequency Range                                      | 8 ~ 50 MHz                       |
| Overtone   | Fundamental                      |
| Frequency Tolerance (at 25 °C)                       | ± 10 ppm, ± 20 ppm, ± 50 ppm Max |
| Frequency Stability Over Operating Temperature Range | ± 150 ppm Max.                   |
| Operating Temperature Range                          | - 40 ~ +125 °C                   |
| Drive Level  | 10 μW (typical) ; 300 μW (Max.)  |
| Load Capacitance                                     | 12 pF, or specify                |
| Storage Temperature Range                            | - 40 ~ +125 °C                   |
| Reliability Standard                                 | AEC-Q200                         |

## Equivalent Series Resistance(ESR)

| Fundamental |            |
|-------------|------------|
| 8 ~ 10 MHz  | 150 Ω Max. |
| 10 ~ 12 MHz | 100 Ω Max. |
| 12 ~ 20 MHz | 80 Ω Max.  |
| 20 ~ 50 MHz | 60 Ω Max.  |

## Dimensions

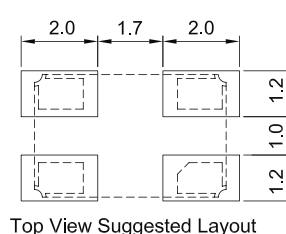
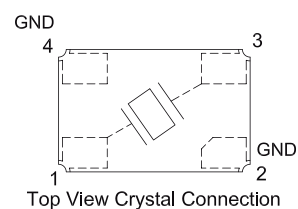
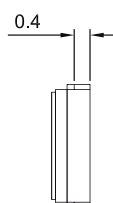
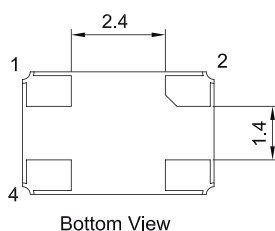
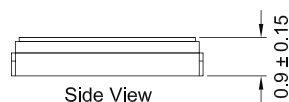
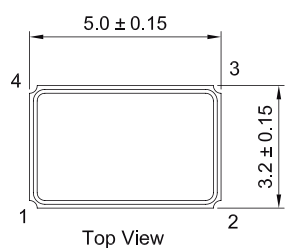

Units: mm